

ORDINANCE NO._____

An ordinance amending Section 12.04 of the Los Angeles Municipal Code by amending the zoning map.

THE PEOPLE OF THE CITY OF LOS ANGELES DO ORDAIN AS FOLLOWS:

SECTION 1. Section 12.04 of the Los Angeles Municipal Code is hereby amended by changing the zone classifications on properties shown upon portions of the Zoning Map and the table for Section 1 below and incorporated herein by this reference, and made a part of Article 2, Chapter 1 of the Los Angeles Municipal Code.

Table 1 for Section 1

Existing Zone	New Zone
RE15-1	RE15-1-HCR
RE15-1-H	RE15-1-H-HCR
RE20-1	RE20-1-HCR
RE20-1-H	RE20-1-H-HCR
RE40-1	RE40-1-HCR
RE40-1-H	RE40-1-H-HCR

SECTION 2. Pursuant to Section 12.32 F of the Los Angeles Municipal Code, and any amendment thereto, the use of that property described in Section 1 hereof are subject to the regulations of the Hillside Construction Regulation "HCR" Supplemental Use District regulations pursuant to Section 13.20 of the Los Angeles Municipal Code

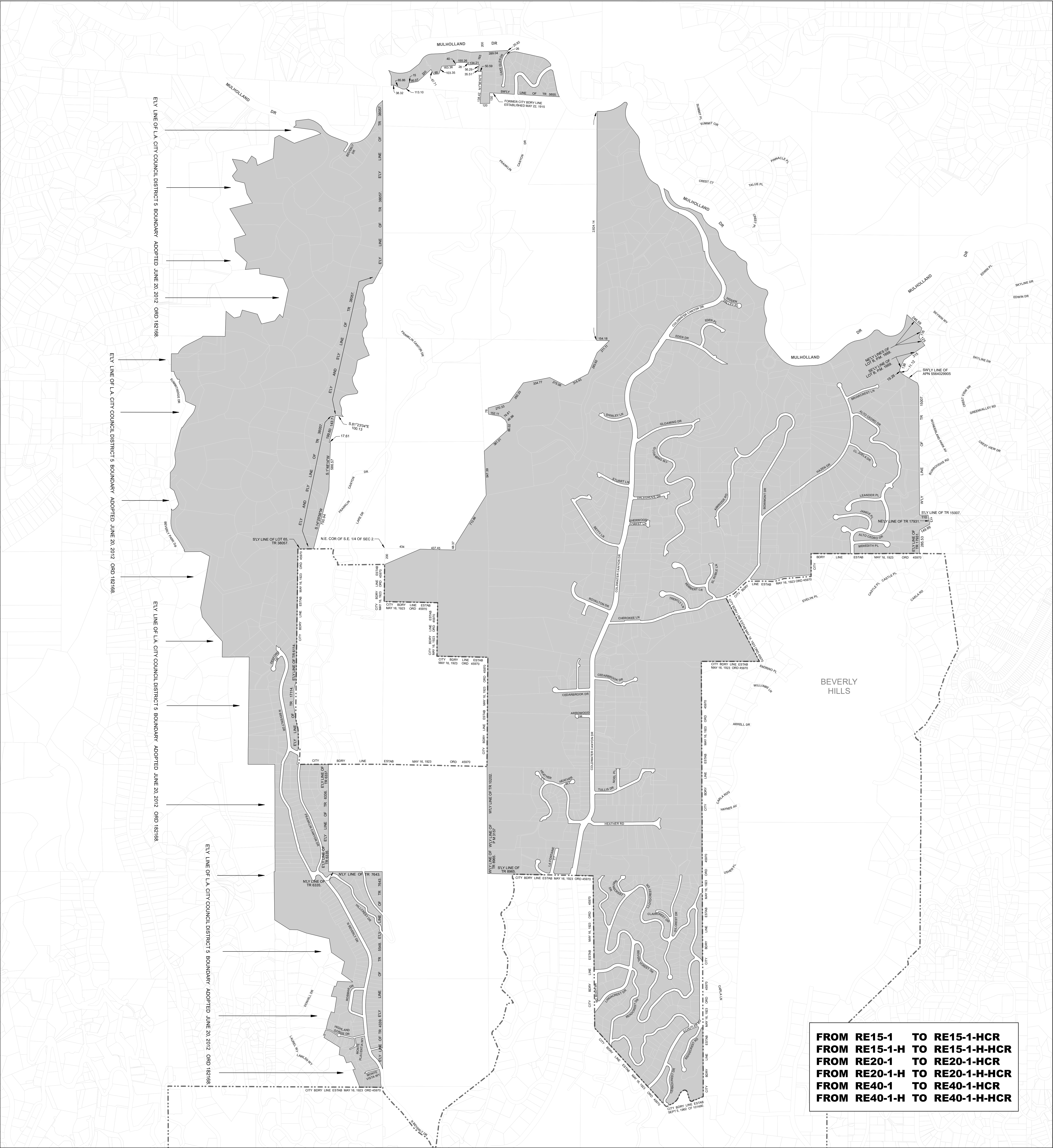

Hillside Construction Regulation "HCR" District Zone Change
Coldwater/Franklin Canyon Expansion

DATA SOURCES: DEPARTMENT OF CITY PLANNING-
DEPARTMENT & BUREAU OF ENGINEERING

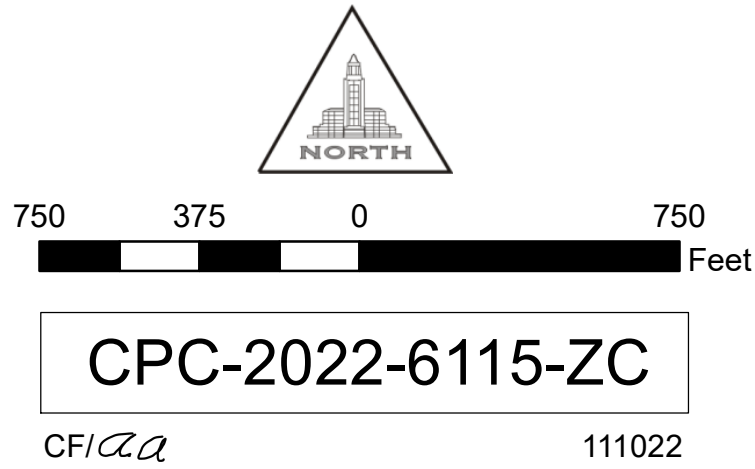

ALL ZONING AND HEIGHT DISTRICTS IN THE
AFFECTED AREA REMAIN THE SAME. SUFFIX
-HCR WAS ADDED BECAUSE THE AREA IS NOW
INCLUDED IN THE HILLSIDE CONSTRUCTION
REGULATION "HCR", CPC-2022-6115-ZC.

